



“STEAL THIS IDEA!” WORKSHOP

Actionable Strategies for Vibrancy at Any Scale

GROUP FACILITATORS

- Richard Amore, Planning and Outreach Manager
- Gary Holloway, Downtown Program Manager
- Dan Groberg, Community Planning and Project Manager: VT Department of Housing and Community Development
- Meg Staloff, Southern Vermont Economy Project Manager, BDCC

LOCAL PROJECT PRESENTERS

- Jenny Dewar, Better Bennington Association (Popup Shops)
- Kate Trazkos, Downtown Brattleboro Alliance (Gallery Walk)
- Dunham Rowley, Chair of Guilford Park Committee (Guilford Pavilion Project)
- Ben Lamb, Director of Economic Development, 1 Berkshire (North Adams)

Sponsored by



Bennington:

Using Popups to promote local business/fill empty spaces





Try Our Great New Vinegars!
Italian Vinegar
Garlic and Chives
Scarborough Fair
Pepper Vinegar





Lodestar Lights
CANDLES, SUNCATCHERS, TIE DYE
& CRYSTALS
lodestars33@gmail.com
www.lodestarscoach.com
802.319.5775

EXIT

SE
GN
IN DECOR







Rockwood Studio
Bennington, VT
802-688-4394
Handmade Pottery by
Sarah Crawford

Thank you

Scan to Pay

Noodle Bowls
Great way to serve ramen
and fry of food!
They really are great and so
easy to make!

Home Sweet Home

LIVE * LAUGH * LOVE





Mother's Day
is Sunday, May
14th
Get Mom and make
her feel special.

Aroma Stones
moisturizing soap/pumice to
scrub away dead, tough skin & grime.
\$8ea OR 2/\$14

Odor-Eliminating
Linen Spray
Large 4oz size: \$10 or 2/\$18
Small 2oz size: \$6 or 2/\$10
Try our testers!

Try Me!
Sniff...
Spritz on paper...
Smile paper...
Sniff!

Shower Puffs
\$3ea or 2/\$5

Sniff
Me!
↑

Lucid Dreams Oil
Anoint your 3rd eye & pulse
points to let bed to experience
Vivid dreams.
\$10ea OR 2/\$18

Shower
Steamers
\$4ea 2/\$6

Beard Oil
w/ Castor, Argan & Jojoba oils
to promote hair growth &
soft, manageable w/ that subtle
irresistible
\$15ea or 2/\$25

Face, Hair &
Nail Oils
\$15ea or 2/\$25

Try our Salve!
Use a wood stick to
scrape a small amount from
tin, apply to skin; rub in.
Sniff.

Gentle Mint 3-in-1
Baths
\$9ea or 2/\$16

Hemp, Jojoba, Tamanu &
Beeswax Salve.
For dry, hard skin.
\$10ea OR 2/\$18

Handmade Soap
Locally made!
\$8ea or 2/\$14



Wicked Sniffer
Aromatherapy Co.
wickedsniffer.com

Brattleboro:

Using Downtown Events to Create, Harness, and Leverage Vitality









**FIRST
PROOF
PRESS**

HANDMADE ART - WORKSHOPS
MEMBERSHIPS - ART GALLERY
MONOTYPE - PHOTOPOLYMER
WOODCUT - LETTERPRESS
ETCHING - SCREEN PRINTING

Come
We Are
OPEN

First Proof Press
183 Main Street
Brattleboro, VT 05701
(802) 452-1111
firstproof.com

more info at brattleboro.com

follow us at [@downtownbrattleboro](https://www.instagram.com/downtownbrattleboro)

LIVE MUSIC

ART STATIONS

MAKERS MARKET

GALLERIES

FOOD COURT

DOWNTOWN FUN

FIRST FRIDAYS | 5-9 PM
MAY-DECEMBER 2023

**GALLERY
WALK**
BRATTLEBORO, VERMONT



Guilford:

Leveraging Community Interest to Fund and Drive a Project

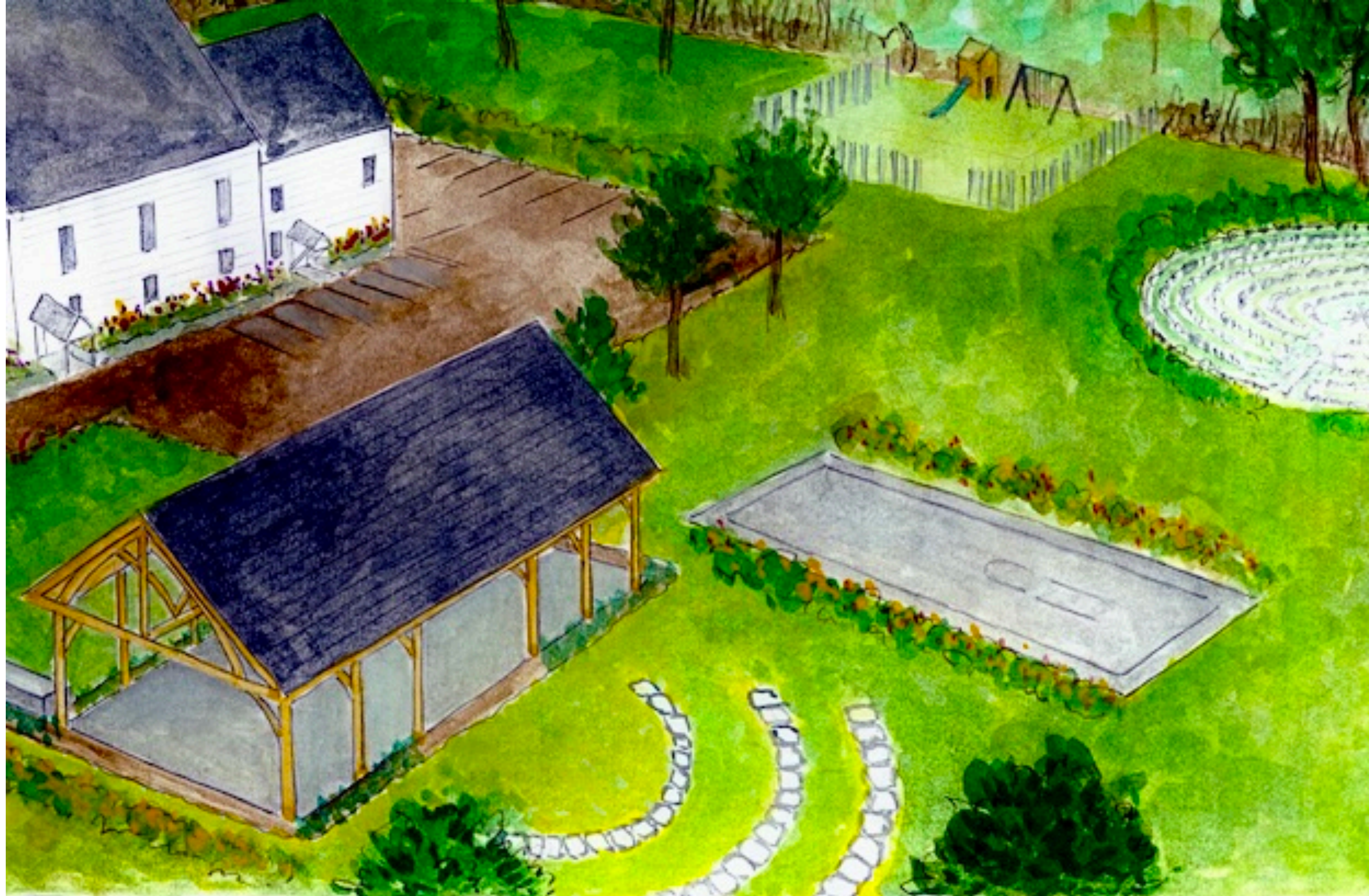

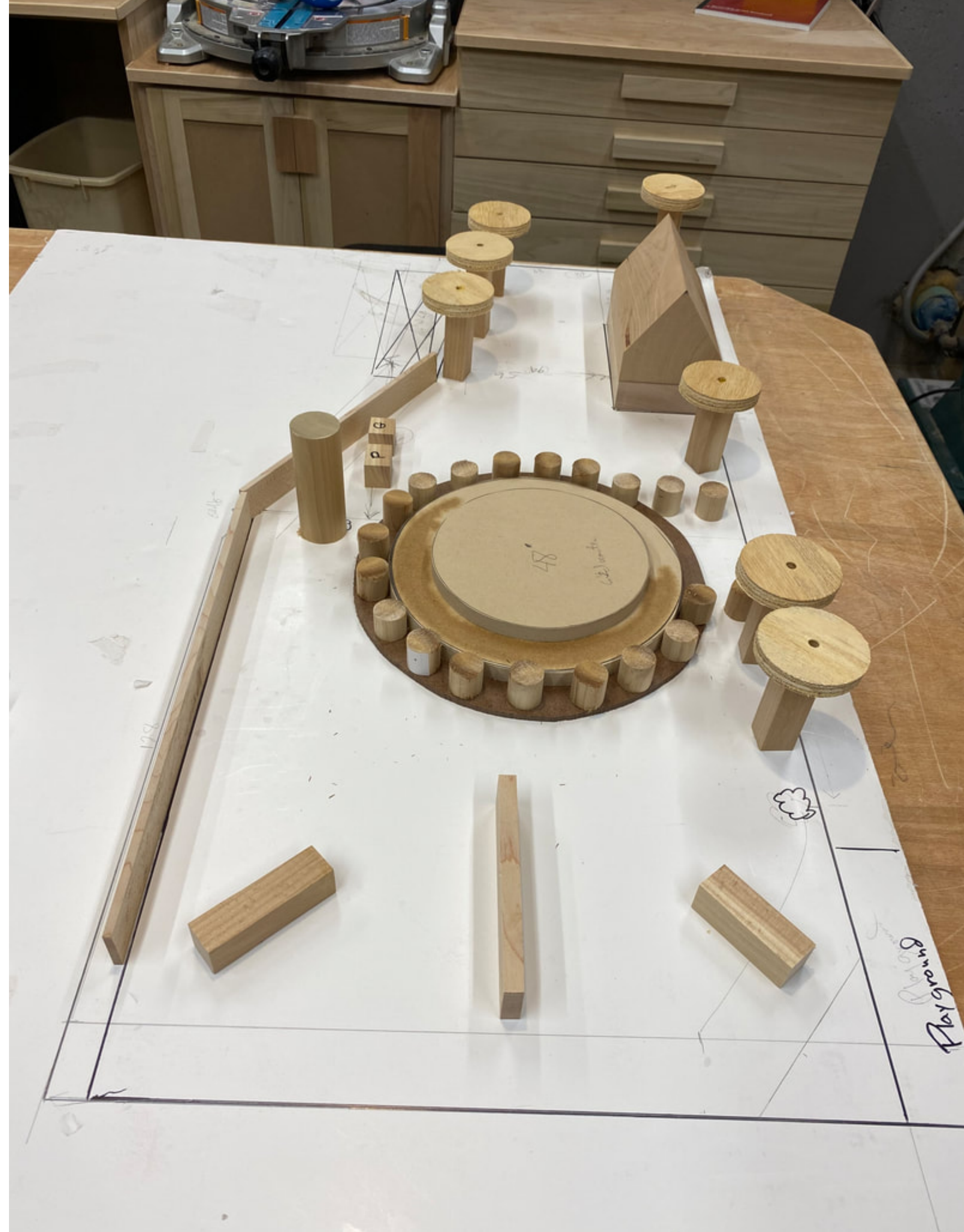















GUILFORD COMMUNITY PARK

[Home](#) [Pavilion](#) [Labyrinth](#) [Green Space](#) [Events](#) [Contact](#) [About](#)

GUILFORD COMMUNITY PARK

MISSION: Creating and fostering community through shared recreational experiences.

[LEARN MORE](#)

A RICH AND ENGAGING COMMUNITY SPACE IN THE HEART
OF GUILFORD'S ALGIERS VILLAGE

North Adams:

Strategy to Drive Local Economic and Community Development























NORTH ADAMS





BREAKOUT GROUPS



POPUPS!

- Jenny Dewar, Events Director, Better Bennington Association
- Gary Holloway, VT Downtown Program Manager

LEVERAGING EVENTS FOR VITALITY

- Kate Trazkos, Downtown Brattleboro Alliance
- Dan Groberg, Community Planning and Project Manager: VT Department of Housing and Community Development

GETTING COMMUNITY BUY-IN & PARTICIPATION

- Dunham Rowley, Chair of Guilford Park Committee
- Richard Amore, Planning and Outreach Manager

STRATEGIES FOR TRANSFORMATION

- Ben Lamb, Director of Economic Development, 1 Berkshire
- Meg Staloff, SVEP Program Manager, BDCC



Sponsored by

